



F77/150 - IMC Mistral M60
Bottle Cooler [Front
Load] - Glass Door -
Stainless Steel Frame - H
900 mm - W 600 mm -
0.225 kW

With eye-catching style and exceptional performance, the Mistral M60 bottle cooler keeps drinks at the perfect serving temperature, making it the ideal choice for commercial bars.

- ✓ Stylish, flexible storage for up to 120 bottles
- ✓ Electronic temperature controller and auto defrost for perfectly-chilled drinks
- ✓ Energy-efficient forced air cooling for rapid temperature pull down
- ✓ Sleek stainless steel interior and LED lighting to enhance display
- ✓ Single double-glazed lockable door for enhanced security
- ✓ UK 3 pin plug allows users to simply plug in and switch on
- ✓ Easy to remove and replace magnetic gaskets to facilitate cleaning

Specifications

Summary

| | |
|-----------------------------|-----------------------------------|
| Brand | IMC |
| Range | Mistral |
| Power Type | Electric |
| Unit Type | Free-standing |
| Available in UK Only | No |
| UK Warranty | 2 Years Parts and Labour Warranty |
| Export Warranty | Contact your local dealer |
| GTIN | 5056105198291 |

Power and Performance

| | |
|-----------------------------|------------|
| Total Power kW | 0.225 |
| Temperature Range °C | 2-6 |
| IP Rating | IPX1 |
| Temperature Control | Electronic |

Key Specifications

| | |
|-----------------------------------|-----------------|
| Door Hinge | Right |
| Door Location | Front |
| Lockable Door | Yes |
| Colour | Stainless Steel |
| Number of Doors | 1 |
| Reversible Door | Yes |
| Number of Shelves included | 2 |
| Number of Shelf Positions | 29 |
| Refrigerant Type | R290 |
| Type of Lighting | LED |

Capacity

| | |
|-------------------------|-----|
| Capacity Bottles | 120 |
| Capacity Litres | 133 |

Weights and Dimensions

| | |
|----------------------------------|------|
| Unit Height (External) mm | 900 |
| Unit Width (External) mm | 600 |
| Unit Depth (External) mm | 500 |
| Height (Internal) mm | 755 |
| Width (Internal) mm | 526 |
| Depth (Internal) mm | 377 |
| Shelf Dimensions Width mm | 510 |
| Shelf Dimensions Depth mm | 373 |
| Net Weight Kg | 59.5 |

Supply Connections

| | |
|---------------------------------------|------|
| Requires Installation | No |
| Requires Electrical Supply | Yes |
| UK 3 Pin Plug | Yes |
| Requires Hardwiring | No |
| Electrical Supply Rating Watts | 225 |
| Single Phase Amps | 1.65 |
| Single Phase Voltage | 240 |

Shipping

| | |
|-------------------------|-------|
| Packed Weight Kg | 65.45 |
| Packed Height cm | 108 |
| Packed Width cm | 68 |
| Packed Depth cm | 58 |

Available Accessories

| | |
|-------------------|---|
| A12/091/Z1 | Wire Shelf - Chrome - for M60 Bottle Cooler |
| A12/100 | Wine Shelf - Chrome - for M60 Bottle Cooler |

Technical Picture

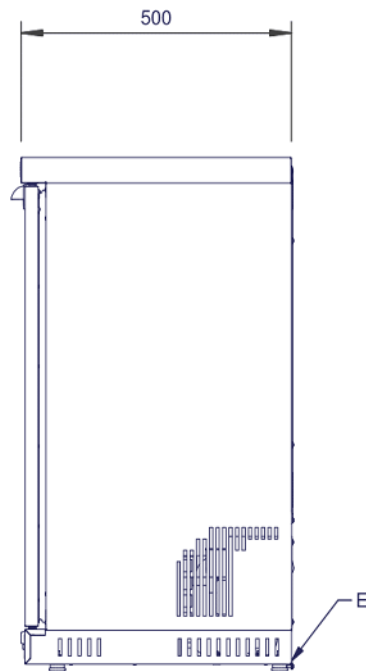
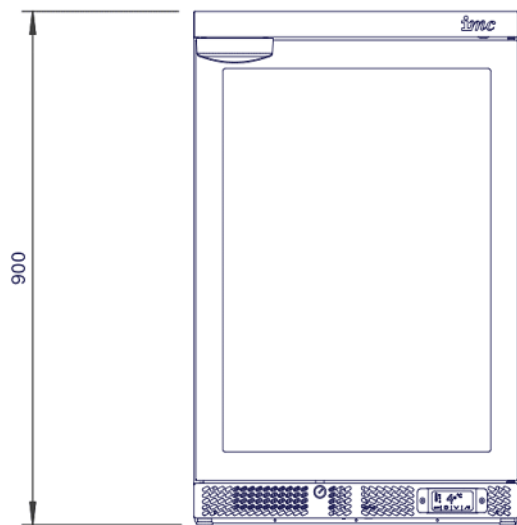
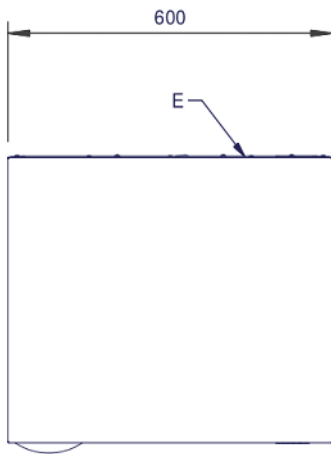



Lincat Limited

Whisby Road,
Lincoln, LN6 3QZ,
United Kingdom

Company No: 2175448

A member company of



Customer Care

Tel: +44 1522 875500
Email: care@lincat.co.uk

Export Customers

Tel: +44 1522 875536
Email: export@lincat.co.uk

Opening Hours

Monday – Friday:
8.30am – 5pm